

## Large Bow Shackles c/w Type A Screw Collar Pin

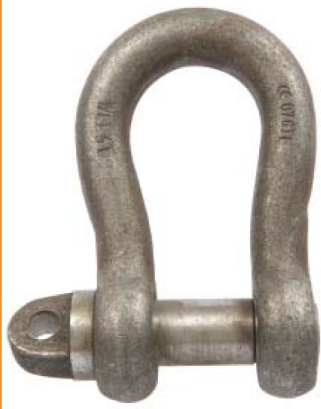

- Meets the performance requirements of the now withdrawn standard BS3032.
- Higher tensile steel, similar to Grade 4, finish available.
- Self coloured and hot dip galvanised.
- Proof load tested 2 times the W.L.L.
- Minimum breaking load is 4 times the W.L.L.
- Marked with the manufacturers mark, size ID mark and W.L.L.

self colour code	galvanised code	W.L..L (tonnes)	A (inches)	B (inches)	C (inches)	D (inches)	E (inches)	weight (kgs)
B4552	B5551	0.45	3/8	1/2	5/8	1 1/8	1	0.18
B4553	B5552	0.75	1/2	5/8	7/8	2 1/8	1 1/4	0.34
B4554	B5553	1.25	5/8	3/4	1 1/8	2 3/4	1 1/2	0.65
B4555	B5554	2.00	3/4	7/8	1 3/8	3 3/8	1 3/4	1.08
B4556	B5555	2.75	7/8	1	1 5/8	3 7/8	2	1.80
B4557	B5556	3.75	1	1 1/8	1 3/4	4 1/4	2 1/4	2.46
B4558	B5557	4.75	1 1/8	1 1/4	2	4 7/8	2 1/2	3.47
B4559	B5558	5.75	1 1/4	1 3/8	2 1/4	5 3/8	2 3/4	4.56
B4560	B5559	7.25	1 3/8	1 1/2	2 1/2	6	3	6.07
B4561	B5560	8.50	1 1/2	1 3/4	2 3/4	6 5/8	3 1/2	8.35
B4562	B5561	9.50	1 5/8	1 7/8	3	7 3/8	3 3/4	11.81

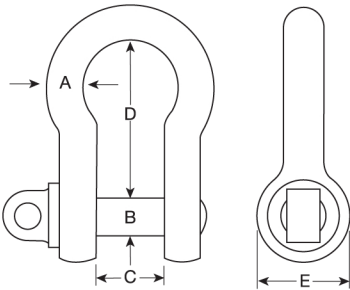

## Small Bow Shackles c/w Type A Screw Collar Pin

- Meets the performance requirements of the now withdrawn standard BS3032.
- Higher tensile steel, similar to Grade 4, finish available.
- Self coloured and hot dip galvanised.
- Proof load tested 2 times the W.L.L.
- Minimum breaking load is 4 times the W.L.L.
- Marked with the manufacturers mark, size ID mark and W.L.L.

self colour code	galvanised code	W.L..L (tonnes)	A (inches)	B (inches)	C (inches)	D (inches)	E (inches)	weight (kgs)
B1551	B3552	0.45	3/8	1/2	5/8	1 1/2	1	0.18
B1552	B3553	0.75	1/2	5/8	7/8	2	1 1/4	0.34
B1553	B3554	1.25	5/8	3/4	1 1/8	2 1/2	1 1/2	0.62
B1554	B3555	2.00	3/4	7/8	1 3/8	3	1 3/4	1.05
B1555	B3556	2.75	7/8	1	1 1/2	3 1/2	2	1.63
B1556	B3557	3.75	1	1 1/8	1 3/4	4	2 1/4	2.28
B1557	B3558	4.75	1 1/8	1 1/4	2	4 1/2	2 1/2	3.20
B1558	B3559	5.75	1 1/4	1 3/8	2 1/4	5	2 3/4	4.54
B1559	B3560	7.25	1 3/8	1 1/2	2 3/8	5 1/2	3	5.74
B1560	B3561	8.50	1 1/2	1 3/4	2 5/8	6	3 1/2	8.51
B1561	B3562	9.50	1 5/8	1 7/8	2 7/8	6 1/2	3 3/4	11.23